

Camera Wall Plate **INSTRUCTION MANUAL**

v1.0. Please check
getkuna.com/manual/cwp/
for the latest version



Need support or more information?

Visit help.getkuna.com, email us at support@getkuna.com, or call
1-844-905-1914, Mon-Fri 8:00 AM-5:30 PM Pacific Time

PACKAGE CONTENTS

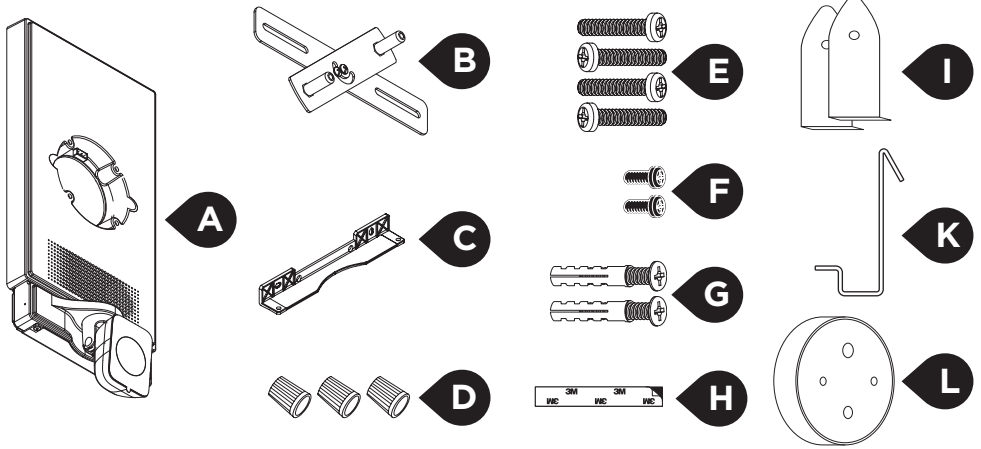

PARTS PROVIDED Required

- A** 1 × Camera Wall Plate
- B** 1 × Camera Wall Plate Mounting Bracket
- C** 1 × Camera Bar Bracket
- D** 3 × Wire nuts
- E** 4 × Mounting Screws
- F** 2 × Machine Screws

PARTS PROVIDED Optional

- G** 2 × Anchor Screws with Anchors
- H** 1 × Double sided tape
- I** 2 × Metal Arrow Shims
- K** 1 × Fixture holding hook
- L** 1 × Round adapter plate
(Needed only for upgrading a Kuna Camera Porch Light)

NOT PROVIDED

- 1 × Light Fixture
- 1 × Light Bulb
- 1 × SD Card (Optional)

UL INFO This product must be mounted at least 4 feet off the ground. The camera wall plate is designed to be used with a compatible light fixture. To be compatible, the light fixture should a. support standard AC power (0.25-0.54A, 240V-110V-, 50/60Hz) and a standard light bulb (60W maximum), and, b. should have a mounting plate that physically fits on the wall plate. Most light fixtures will fit, but the specifications are that the mounting plate should cover the central hole in the camera wall plate (3.85" diameter), its width should be less than that of the wall plate (6.5") and its top less than 5.75" from the mounting screw (i.e., lower than the top of the camera wall plate when mounted). See figure on the right. This will allow for the gap between the light fixture and the wall plate to be water-proofed with a sealant (see step 6 below).

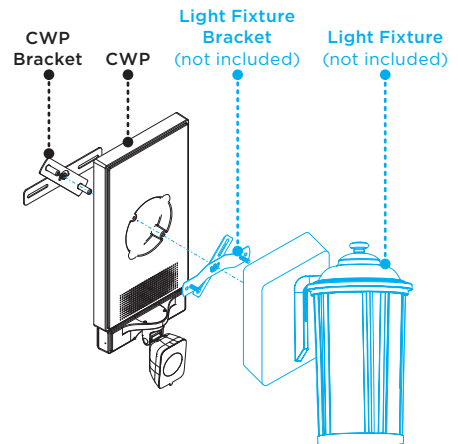

SAFETY INFORMATION. WARNING

- Risk of fire or electric shock. 120V light installation requires knowledge of luminaires electrical systems. If not qualified, do not attempt to install. Contact a qualified electrician.
- Disconnect power at fuse or circuit breaker before installing or servicing.
- No user serviceable parts inside. To avoid electrical shock, do not disassemble product.
- To prevent wiring damage or abrasion, do not expose wiring to edges of sheet metal or other sharp objects.
- Use only on 0.25-0.54A, 240V-110V-, 50/60Hz circuits, and with maximum 60W light bulb.

Any changes or modifications not expressly approved by the party responsible for compliance could void the user's authority to operate the equipment. Please read and understand this entire manual before attempting to assemble, install, or operate this light fixture. Your government may regulate the use of security cameras and other recording devices. It is the purchaser's sole responsibility to ensure compliance with all applicable laws and to provide any legally required notices. Check local laws regulating the use of any recording devices and cameras prior to installation.

INFORMATIONS DE SÉCURITÉ. AVERTISSEMENT

- Risque de décharge électrique. L'installation de lampes de 120 V exige une connaissance des systèmes électriques des luminaires. Ne tentez pas l'installation si vous n'êtes pas qualifié. Faites appel à un électricien qualifié.
- Déconnectez l'alimentation électrique au niveau du fusible ou du disjoncteur avant l'installation ou l'entretien.
- Le produit ne contient aucune pièce susceptible d'être réparée par l'utilisateur. Pour éviter toute décharge électrique, ne démontez pas le produit.
- Pour empêcher tout dégât ou abrasion aux fils, n'exposez pas les fils aux bords de feuilles de métal ou à d'autres objets tranchants.
- Ne l'utilisez que sur des circuits de 0.25 - 0.54 A, 240V-110V-, 50/60Hz, et avec une ampoule de 60 W maximum.

Tout changement ou modification non expressément approuvé par la partie responsable de la conformité peut annuler le droit de l'utilisateur à faire fonctionner l'équipement. Veuillez lire et comprendre l'intégralité de ce manuel avant d'essayer d'assembler, d'installer ou d'utiliser ce luminaire. Votre gouvernement peut réglementer l'utilisation des caméras de sécurité et des autres appareils d'enregistrement. Il est la seule responsabilité de l'acheteur de s'assurer du respect de toutes les lois applicables et de fournir les avis légalement requis. Vérifiez les lois locales régissant l'utilisation de tous les appareils d'enregistrement et caméras avant l'installation.

PREPARATION

Before beginning assembly of product, make sure all parts are present. Compare parts with package contents list. If any part is missing or damaged, do not attempt to assemble the product.

TOOLS NEEDED Phillips screwdriver, step ladder, silicone sealant

For retrofitting Kuna Camera Porch Light sconce only: slip joint pliers, wire stripper (on the right).



Kuna-SE App

Before installation, on your iOS or Android smartphone, please visit getkuna.com/app to download and install our free Kuna-SE App.

Follow in-app instructions to set up your Kuna Camera Wall Plate at Step 8.



INSTALLATION

The instructions that follow show the CWP installed with its camera at the bottom. You can also choose to install with the camera at the top by rotating the device 180 degrees.

If you are upgrading a Kuna Camera Porch Light, first read the instructions in the Appendix on page 6. Follow steps 1 and 2 below, then steps K1 to K5 in the Appendix, and resume at step 3.

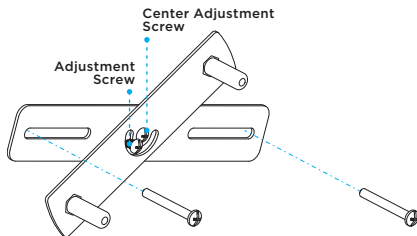

1

Attach the proprietary CWP mounting bracket to the junction box using two mounting screws. If the screws provided are not long enough, reuse the ones used previously in this junction box. Make sure the wires from the junction box remain accessible outside.

Loosen the adjustment screw, and adjust the angle between the two arms of the mounting bracket so that the mounting posts are in the appropriate position for the mounting holes on the CWP (i.e. directions NE & SW or NW & SE). Snug, but do not tighten the adjustment screw.

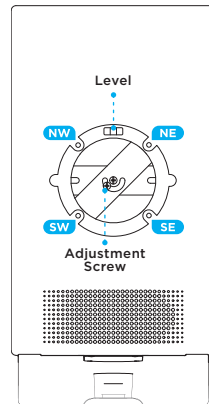

2

Place the CWP so the mounting holes fit on the mounting posts. Use the built-in level to adjust. Now tighten the adjustment screw. Ensure the wires from the junction box and the CWP remain accessible outside.

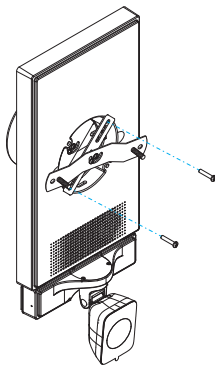

3

Attach the light fixture bracket to the CWP by threading two mounting screws through the arm of the light fixture bracket into the two mounting posts of the CWP mounting bracket. Adjust and level the light fixture bracket.

The Camera Wall Plate should only be mounted with the camera below the light fixture.

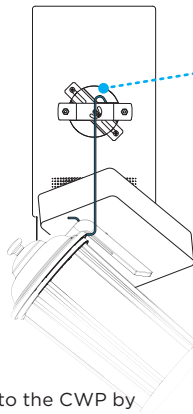

4

Adjust the screw height so that your fixture's plate can be fitted on snugly using its decorative nuts. The provided holding hook (K) is designed to show the height for Kuna devices. Use the hook to suspend the light from the fixture bracket you just installed, this will free up your hands for the wiring in the next step. You may need to lower the camera bar to make room for the hanging fixture.

Light Fixture Plate

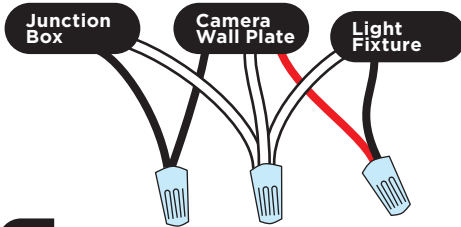

5

Connect the wiring. Make sure you have a secure connection.

BLACK WIRE CWP ↔ Junction Box

WHITE WIRE CWP ↔ Junction Box ↔ Light Fixture

RED WIRE CWP ↔ **BLACK WIRE** Light Fixture
The Red Wire is AC Power controlled by the CWP.

Attach your fixture's ground wire between the junction box ground and the fixture bracket. We recommend using a ground wire even if your fixture does not provide one. Push all 3 wire nuts inside the junction box for safety.

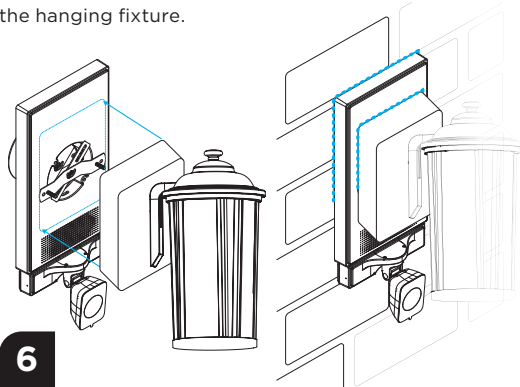

6

Now that the wiring is connected, mount your light fixture, following its specific instructions. If a light bulb is not inside already, put it in. (maximum wattage: 60W) Typically, you will slide the light fixture over two screws attached to the mounting bracket, and secure the light with decorative nuts.

We strongly recommend you use silicone caulking to seal the gap between the wall and the Camera Wall Plate, as well as the gap between the Light Fixture and the Camera Wall Plate. Proper caulking will ensure that water does not enter the wall or the light fixture.

IMPORTANT Caulk only the upper $\frac{2}{3}$, leaving the lower $\frac{1}{3}$ uncaulked (dotted outline in diagram) to enable drainage of any water that seeps in.

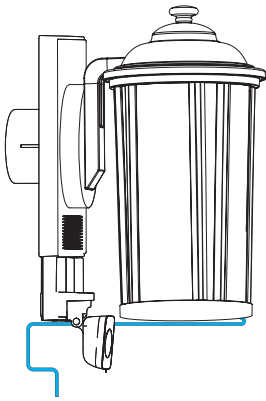

7

It is important that the camera view is not obstructed by the light fixture. Your fixture may need the camera bar to be pulled down so the view is not obstructed. (None of the Kuna models require this). Follow the steps on the right to adjust the camera height to avoid obstruction by the light fixture.

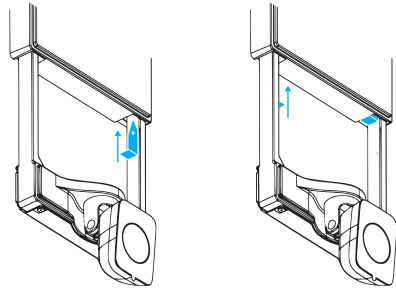

A Pull down the Camera Bar with the Camera Module to the same height as the bottom of your Light Sconce.

B Place an Arrow Shim to the inside of the Pull Rod. Use one hand to hold the Camera Bar in position and use the other hand to push the Arrow Shim up until it is secured or all the way in.

C Repeat on the other side of the Pull Rod.

NOTE you may need to fine tune this adjustment after using the app to look at the live view from the camera.



8

Once adjusted, but before securing the the CWP to the wall, reconnect power to fuse or circuit breaker, and follow the instructions in the app for WiFi setup. Using the app make sure camera view is as desired and is unobstructed. Now secure the CWP to the wall.

Verify the camera position and readjust if needed.

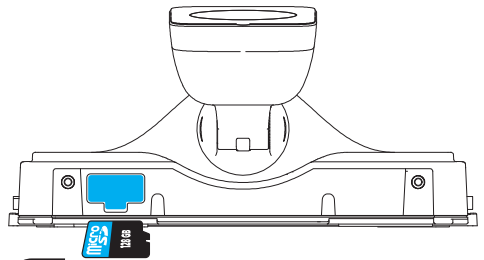

9

OPTIONAL NEW FEATURE IN KUNA-SE

The Camera Wall Plate supports a micro-SD card (not included, up to 1 TB) for 24/7 video storage. We recommend: 64 GB for 5 days of 24/7 recording or 128 GB for 10 days of 24/7 recording. Please refer to the SD card manufacturer's guidelines before installing.

TO INSTALL make sure the CWP is powered off. Use a fingernail to pry open the rubber cover of the micro-SD card slot. Insert the micro-SD card into the slot. Push down until you hear it click into place.

TO REMOVE make sure the CWP is powered off before removing the micro-SD card.

10

Secure the camera bar bracket to the camera bar using the two small machine screws. This will discourage unauthorized access to the SD card, and also enhances the elegance of your new Camera Wall Plate!

OPTIONAL In addition, you can also fix the bar bracket to the wall.

For rough walls (such as stucco), drill holes, and use the supplied anchors and anchor screws.

For smooth walls, use the supplied double-sided (removable) tape behind the bracket.

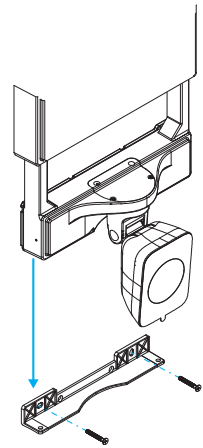

APPENDIX

UPGRADE YOUR KUNA CAMERA PORCH LIGHT

Start the steps below after step 2 above.

TOOLS NEEDED Phillips screwdriver, step ladder, slip joint pliers, wire strippers, Fixture Holding Hook.

K1

Disconnect power at fuse or circuit breaker. Once you have verified that the light is no longer receiving power, it's safe to remove the old Camera Porch Light and start the installation process.

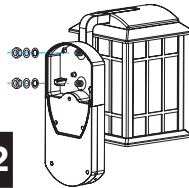

K2

Use a pair of slip joint pliers to remove both sets of hex nuts and washers on the CPL wall plate; you will reuse them in the same order in step K5. The bolts should remain on the plate.

K3

Carefully snip the two wires (black and white) that connect into the light fixture. It is best to cut off as little as possible to allow for easy connection - you can trim them again later if necessary. Strip and expose about an inch of bare wire on both.

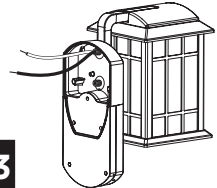

K4

Remove the old Kuna wall plate from the sconce. Cleaning the sconce before reinstalling will make it as good as new!

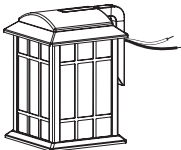

K5

Place the round adapter plate over the Porch Light sconce. Using your fingers, lower the height of the two "bolts" in the Porch Light so they fit below the rim of the round plate. Reuse the hex nuts and washers in the same order and tighten the two bolts.

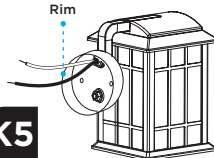

RESUME AT STEP 3 ON PAGE 4

Get powered. Get the app.

Welcome to the next generation in smart security



Your Kuna Camera Wall Plate installs in minutes using existing wiring. It's powered by the Kuna-SE app for wireless intelligence.



Activate your CWP now! Visit getkuna.com/app to download the Kuna-SE app on your Apple or Android mobile device.



Create your account and connect your light.



FCC STATEMENT

KNA-CWP01-BK-01

WARNING: Changes or modifications to this unit not expressly approved by the party responsible for compliance could void the user's authority to operate the equipment.

NOTE: This equipment has been tested and found to comply with the limits for a Class B digital device, pursuant to Part 15 of the FCC Rules. These limits are designed to provide reasonable protection against harmful interference in a residential installation. This equipment generates, uses and can radiate radio frequency energy and, if not installed and used in accordance with the instructions, may cause harmful interference to radio communications.

However, there is no guarantee that interference will not occur in a particular installation. If this equipment does cause harmful interference to radio or television reception, which can be determined by turning the equipment off and on, the user is encouraged to try to correct the interference by one or more of the following measures:

- Reorient or relocate the receiving antenna.
- Increase the separation between the equipment and receiver.
- Connect the equipment into an outlet on a circuit different from that to which the receiver is connected.
- Consult the dealer or an experienced radio/TV technician for help.

This equipment complies with FCC radiation exposure limits set forth for an uncontrolled environment. This equipment should be installed and operated with minimum distance 20cm between the radiator and your body.

This device complies with Part 15 of the FCC Rules. Operation is subject to the following two conditions:

- (1) this device may not cause harmful interference, and
- (2) this device must accept any interference received, including interference that may cause undesired operation.

IC STATEMENT

This device complies with Industry Canada licence-exempt RSS standard(s). Operation is subject to the following two conditions:

- (1) This device may not cause interference, and
- (2) This device must accept any interference, including interference that may cause undesired operation of the device.

This equipment complies with IC RSS-102 radiation exposure limits set forth for an uncontrolled environment. This equipment should be installed and operated with minimum distance 20cm between the radiator and your body.

Le présent appareil est conforme aux CNR d'Industrie Canada applicables aux appareils radio exempts de licence. L'exploitation est autorisée aux deux conditions suivantes:

- (1) l'appareil ne doit pas produire de brouillage, et
- (2) l'utilisateur de l'appareil doit accepter tout brouillage radioélectrique subi, même si le brouillage est susceptible d'en compromettre le fonctionnement.

Ce matériel est conforme aux limites de dose d'exposition aux rayonnements, IC RSS-102 énoncée dans un autre environnement. Cette équipement devrait être installé et exploité avec distance minimale de 20 entre le radiateur et votre corps.

Need support or more information?

Visit help.getkuna.com, email us at support@getkuna.com, or call 1-844-905-1914, Mon-Fri 8:00 AM-5:30 PM Pacific Time